

1

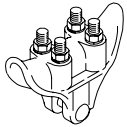

OPTIONS
J-BOLTS
STAINLESS BUSHING
STAINLESS UPGRADE

2

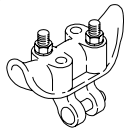

ITEM 2-3 OPTIONS
STAINLESS BUSHING
STAINLESS UPGRADE

3

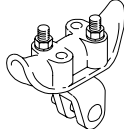

ITEM	DESCRIPTION	PART NO.
------	-------------	----------

SPAN WIRE CLAMP:

1	3/4" Wide Slot, Alum	SE-0321
	5/8" Wide Slot, Alum	SE-4077
	1/2" Wide Slot, Alum	SE-3211
2	90° w/ J-Bolts & 3/4" Slot, Alum	SE-3212
3	Universal w/ 3/4" Wide Slot & J-Bolts, Alum	SE-3217
4	Serrated w/ J-Bolts, Alum	SE-3213
5	1/2" Wide Slot, Iron	SE-0338

WIRE OUTLET BODY:

6	1 1/2" NPS w/ Grommet, 1/2" Wide Comb, Iron	SE-4118
7	Double Universal 1 1/2" NPS, 1/2" Wide Comb, Iron	SE-4155
8	3/4" Wide Comb, Alum	SE-4117
9	3/4" Wide Comb, Brass	SE-0322-B
10	Multi Clevis Tri-Stud, 3/4" Wide Comb, Alum	SE-0558
11	Single Clevis Tri-Stud, 3/4" Wide Comb, Alum	SE-0531
12	Tri-Stud, 3/4" Wide Comb, Alum	SE-0545
13	Tri-Stud Adjustable w/ Grommet, Alum	SE-0523
14	Double Adjustable Tri-Stud, Alum	SE-0532
15	Double Single Clevis 1 1/2" NPS, 3/4" Wide Comb, Alum	SE-4058

4

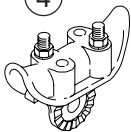

OPTIONS
STAINLESS UPGRADE

5

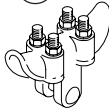

OPTIONS
J-BOLTS
STAINLESS UPGRADE

6

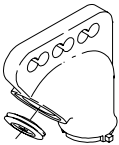

7

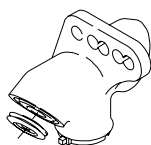

ITEMS 6-7 OPTIONS
DOUBLE SET SCREWS
PAINT

8

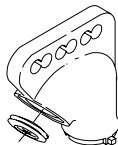

9

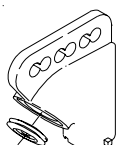

ITEMS 8-9 OPTIONS
DOUBLE SETSCREWS
STAINLESS BUSHING
PAINT

Notes:

- All assemblies are supplied standard with stainless steel fasteners and galvanized hardware on span wire clamps. Stainless upgrade shall include stainless steel hardware on span wire clamps.
- Specify options when ordering.

11

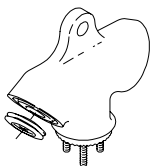

12

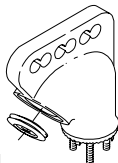

ITEMS 10-12 OPTIONS
STAINLESS BUSHING
PAINT

10

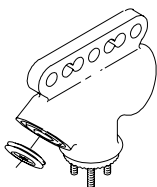

13

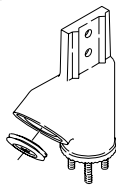

14

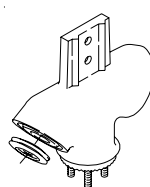

ITEM 13-14 OPTIONS
PAINT

15



OPTIONS
DOUBLE SETSCREWS
STAINLESS BUSHING
PAINT

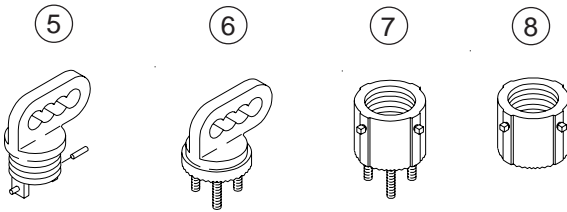
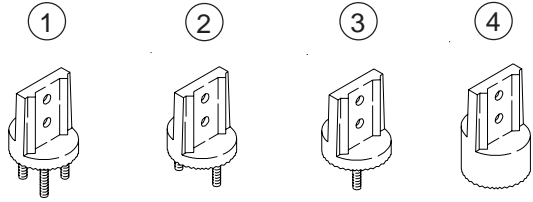

ITEM 1-8 OPTIONS
PAINT

ITEM	DESCRIPTION	PART NO.
HANGER BODY:		
①	Tri-Stud, Alum	SE-0512
②	Double Stud, Alum	SE-0516
③	Single-Stud, Alum	SE-0438
④	1 1/2" NPS, Alum	SE-0530
DISCONNECT BALANCER:		
⑤	1 1/2" NPS, 1/2" Wide Comb, Iron	SE-0380
⑥	Tri-Stud, 3/4" Wide Comb, Alum	SE-0505
⑦	TRI-STUD ADAPTER, 1 1/2" NPS, Alum	SE-0533
⑧	TRI-BOLT ADAPTER, 1 1/2" NPS, Alum	SE-4242
CLEVIS ADAPTER:		
⑨	1 1/2" NPS, 3/4" Clevis, Alum	SE-4030
⑩	1 1/2" NPS, Double, 3/4" Wide Slot, Alum	AB-0316
⑪	Tri-Stud, 3/4" Wide Clevis, Alum	SE-4031
⑫	Single Stud, 3/4" Wide Clevis, Alum	SE-0540
⑬	Single Stud, 3/4" Wide Slot, Alum	SE-0630
⑭	TRI-BOLT/TRI-STUD ADAPTER, 1 1/2" NPS, Alum	SE-0502
⑮	SPAN WIRE ADAPTER, 1 1/2" NPS, Alum w/ Stainless Bushing	SE-0371

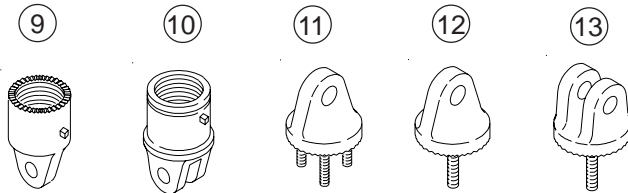

ITEM 9-13 OPTIONS
STAINLESS BUSHING
PAINT

Notes:

1. All assemblies are supplied standard with stainless steel fasteners.
2. Specify options when ordering.

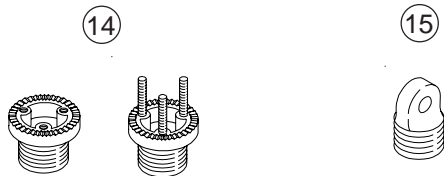

OPTIONS
TRI-BOLT or TRI-STUD

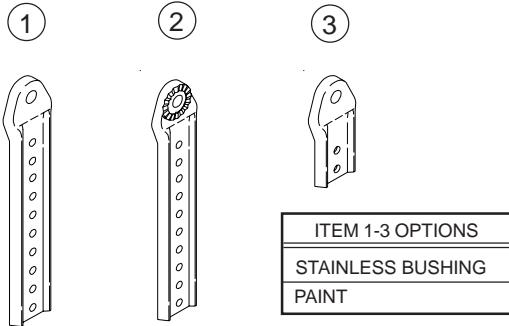

ITEM 1-3 OPTIONS
STAINLESS BUSHING
PAINT

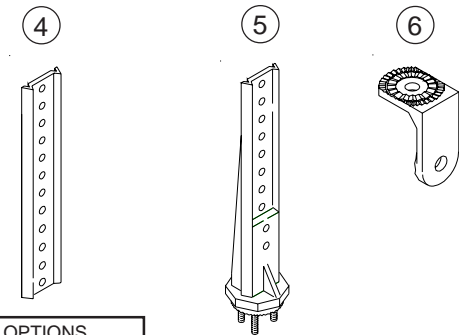

OPTIONS
LENGTH: 11", 19", 40", or 72"
PAINT

ITEM	DESCRIPTION	PART NO.
EXTENDER CONNECTOR HANGER,		
①	10-Hole, Alum	SE-0539
②	10-Hole Serrated, Alum.	SE-0543
③	2-Hole, 1/2" Width, Alum	SE-0508
	2-Hole, 3/4" Width, Alum	SE-0613
④	EXTENDER, Alum	SE-0507
⑤	TRI-STUD HANGER BODY,	
	Adjustable 10-Hole, Alum	SE-0538
⑥	L-SHAPED SIGN ADAPTER, Serrated, Alum	SE-0541
⑦	SIGN HANGER, Serrated, 6" & 14" CTC, Alum	SE-0542
CAST SIGN MOUNT:		
⑧	Single, 16" CTC, Alum	SE-0537
⑨	Double, 16" CTC, Alum	SE-0556
⑩	STABILIZER BAR, 2" x 6", 2-Hole, Alum	SE-0536
⑪	STABILIZER BLOCK, 2" x 6", 2-Hole, Alum	SE-0544
TETHER PLATE:		
⑫	1-Hole, Alum	SE-0510
⑬	2-Hole, Alum	SE-0509
⑭	Slotted, Alum	SE-0515

Notes:

1. All assemblies are supplied standard with stainless steel fasteners and galvanized hardware on span wire clamps.
2. Specify options when ordering.

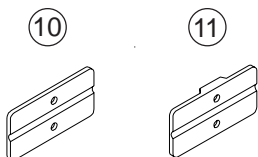
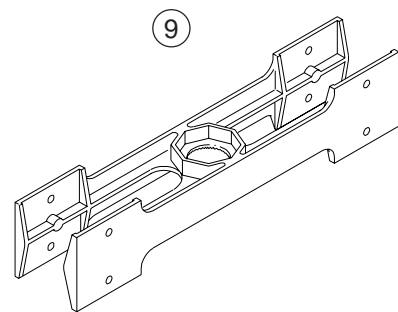
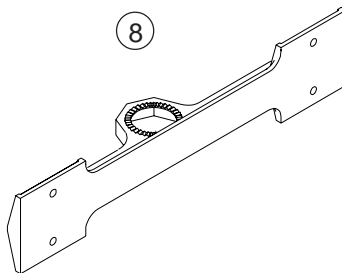
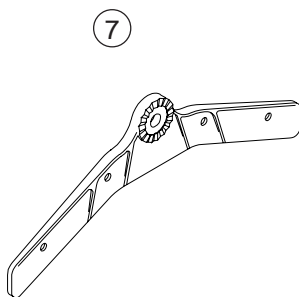

ITEM 5-11 OPTIONS
PAINT

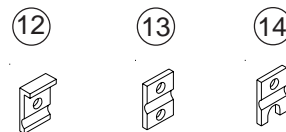

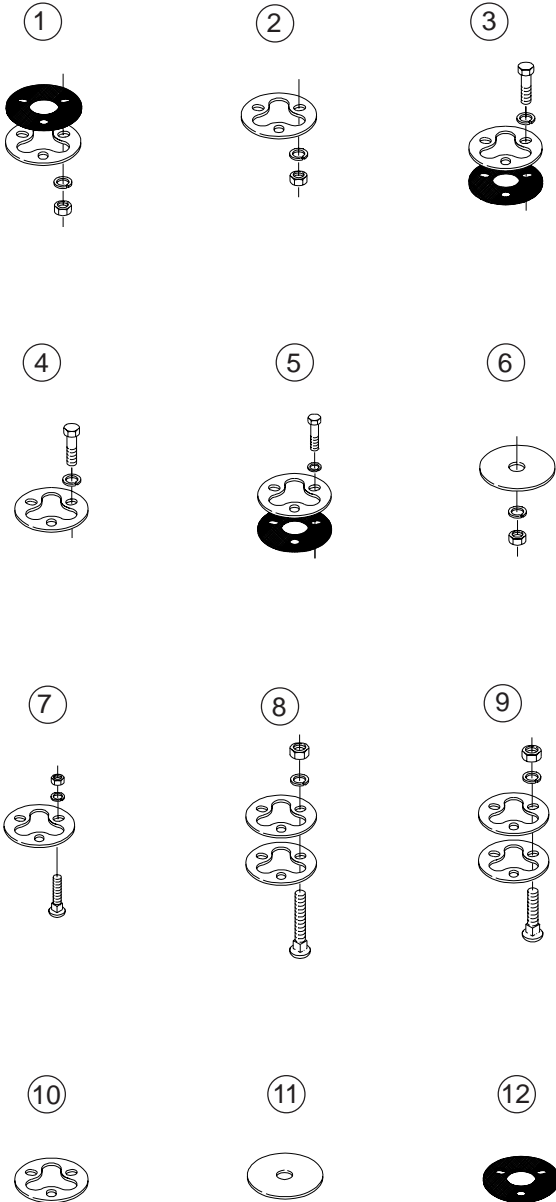

ITEM	DESCRIPTION	PART NO.
①	TRI-STUD HARDWARE KIT w/ Gasket, 5/16"-18 Zinc Slotted Washer & Stainless Hardware	SE-5048
	Stainless Slotted Washer & Stainless Hardware	SE-5123
②	TRI-STUD HARDWARE KIT w/o Gasket, 5/16"-18 Zinc Slotted Washer & Stainless Hardware	SE-5035
	Stainless Slotted Washer & Stainless Hardware	SE-5122
③	TRI-BOLT HARDWARE KIT w/ Gasket, 5/16"-18 Zinc Slotted Washer & Stainless Hardware	SE-5100
	Stainless Slotted Washer & Stainless Hardware	SE-5125
④	TRI-BOLT HARDWARE w/o Gasket, 5/16"-18 Zinc Slotted Washer & Stainless Hardware	SE-5101
	Stainless Slotted Washer & Stainless Hardware	SE-5126
⑤	TRI-BOLT HARDWARE KIT w/ Gasket, 1/4"-20 Zinc Slotted Washer & Stainless Hardware	SE-0398
	Stainless Slotted Washer & Stainless Hardware	SE-4111
⑥	SINGLE-STUD HARDWARE KIT, 5/16"-18 Stainless Single Stud Washer & Stainless Hardware	SE-5064
⑦	LOWER ASSEMBLY KIT, 1/4"-20 Zinc Slotted Washer & Stainless Hardware	SE-3021
	Stainless Slotted Washer & Stainless Hardware	SE-3227
⑧	PLUMBIZER HARDWARE KIT, 5/16"-18 Zinc Slotted Washer & Stainless Hardware	SE-3045
	Stainless Slotted Washer & Stainless Hardware	SE-3282
⑨	SIGNAL TO SIGNAL MOUNTING KIT, 5/16"-18 Zinc Slotted Washer & Stainless Hardware	SE-3117
	Stainless Slotted Washer & Stainless Hardware	SE-4112
⑩	SLOTTED WASHER, Zinc Plated	SE-0375-ZN2
	SLOTTED WASHER, Stainless Steel	SE-0375-SS
⑪	SINGLE-STUD WASHER, Stainless	SE-4113-SS
⑫	SLOTTED GASKET, Neoprene	AB-0278

Notes:

1. All assemblies are supplied standard with stainless steel fasteners.

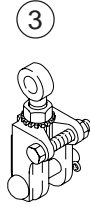
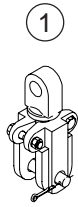

ITEM 1-2 OPTIONS
SLOT: 1/2" or 3/4"
EYEBOLT: 1/2" or 3/4"
PAINT

OPTIONS
SLOT: 1/2" or 3/4"
EYEBOLT: 1/2" or 3/4"

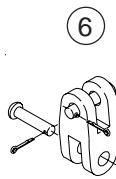
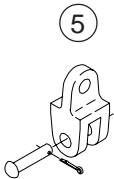
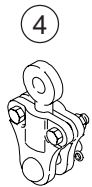

ITEM 5-6 OPTIONS
STAINLESS BUSHING & PINS
PAINT

ITEM	DESCRIPTION	PART NO.
①	PAL BALANCE ADJUSTER, Pivot and Lock	SE-3219
②	BALANCE ADJUSTER:	
	Iron	SE-3108
	Brass	SE-3200
③	Iron w/ Jam Nut & Lockwasher	SE-3191
④	Brass, 3/4" x 3/4"	SE-3068
⑤	CLEVIS HANGER:	
	3/4" Hanger x 3/4" Clevis w/ Pins, Alum	SE-0467
	3/4" Hanger x 1/2" Clevis w/ Pins, Alum	SE-0610
⑥	CLEVIS-CLEVIS:	
	3/4" x 3/4" w/ Pins, Alum	SE-0468
	1/2" x 1/2" w/ Pins, Alum	SE-0464

Notes:

1. All assemblies are supplied standard with stainless steel fasteners and galvanized clevis pins.
2. Specify options when ordering.

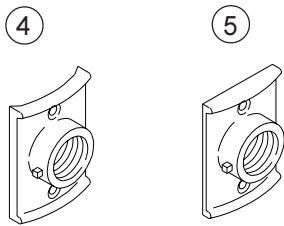
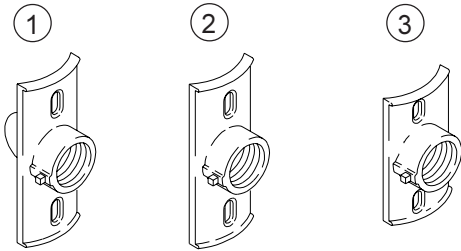

ITEM 1-5 OPTIONS	
DOUBLE SET SCREWS	
1½" NPT THREADS	
PAINT	

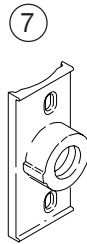
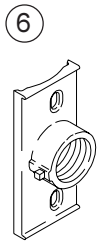

OPTIONS	
DOUBLE SET SCREWS	
REAR HOLE:	
15/16" Dia.	
¾"-14 NPT	
1½" Dia.	
PAINT	

OPTIONS	
THREADS:	
¾"-14 NPT	
3/8"-16 NC	
PAINT	

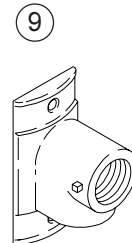
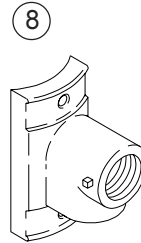

ITEM 8-9 OPTIONS	
1¼" NPT DOWN HOLE	
¾" MOUNTING HOLES	
PAINT	

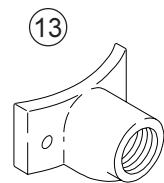
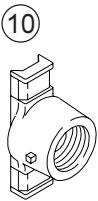

OPTIONS	
DOUBLE SET SCREWS	
1½" NPT THREADS	
REAR HOLE:	
¾" NPT or 15/16"	
PAINT	

OPTIONS	
9/16" MOUNTING HOLES	
DOUBLE SETSCREWS	
1½" NPT THREADS	
PAINT	

OPTIONS	
PAINT	

OPTIONS	
1¼" NPT DOWN HOLE	
PAINT	

ITEM	DESCRIPTION	PART NO.
HUB PLATE:		
①	w/ Cable Guide, 1½" NPS, Alum	SE-0444
②	w/o Cable Guide, 1½" NPS, Alum	SE-0445
	w/o Cable Guide, 1½" NPS, Iron	SE-4124
③	4" Pipe, 1½" NPS, Alum	SE-0454
④	Large Pole, 1½" NPS, Alum	SE-0357
⑤	Flat Back, 1½" NPS, Alum	SE-0415
⑥	Universal, 1½" NPS, Alum	SE-4071
⑦	Universal, Alum	SE-4130
⑧	Extended, 1½" NPS, Alum	SE-0381
⑨	Extended Flat Back, 1½" NPS, Alum	SE-0465
⑩	Narrow, 1½" NPS, Alum	SE-4050
⑪	Single, 1½" NPS, Alum	SE-0111
⑫	Double, 1" NPT, Alum	SE-0112
⑬	Wood Pole, Horizontal, 1½" NPS, Alum	SE-4079

Notes:

1. All assemblies are supplied standard with stainless steel fasteners and natural aluminum alodine coating.
2. Please specify options when ordering.

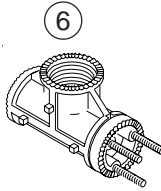
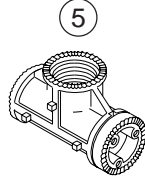
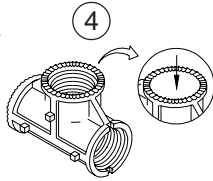
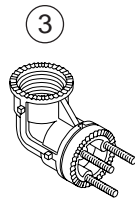
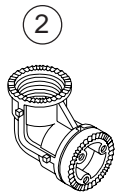
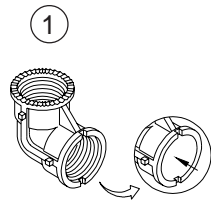

ITEM 1 & 4 OPTIONS
SLIP PORT: 1 Vertical
DOUBLE SETSCREWS
PAINT

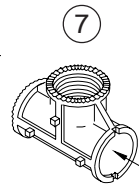

ITEM 2-3 & 5-7 OPTIONS
DOUBLE SETSCREWS
PAINT

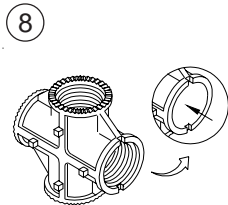

ITEM 8 OPTIONS
SLIP PORT: 1 Vert or 2 Horiz
DOUBLE SETSCREWS
PAINT

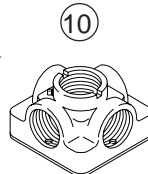
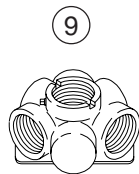

ITEM 9-10 OPTIONS
PAINT

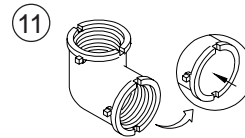

ITEMS 11 OPTIONS
SLIP PORT: 1 Vertical
DOUBLE SETSCREWS
PAINT

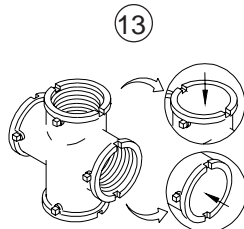
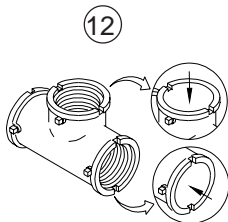

ITEM 12-13 OPTIONS
THREADS: NPS or NPT
SLIP PORT: 1 Vert or 2 Horiz
DOUBLE SETSCREWS
PAINT

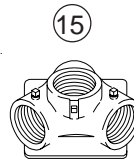
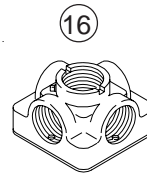
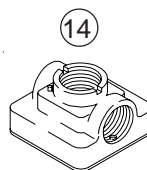

ITEM 14-16 OPTIONS
PAINT

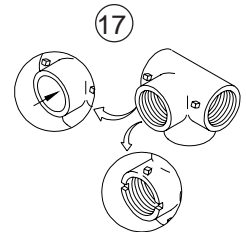

ITEMS 17 OPTIONS
THREAD OPTIONS:
1½" NPT
1½" NPS w/ Notches
1½" NPS w/ Vert Slip
PAINT

ITEM	DESCRIPTION	PART NO.
	ELL, Alum	
①	Serrated	SE-0457
②	w/ Tri-Bolt Adapter	SE-0501
③	w/ Tri-Stud Adapter	SE-0514
	TEE, Alum	
④	Serrated	SE-0458
⑤	w/ Tri-Bolt Adapter	SE-0500
⑥	w/ Tri-Stud Adapter	SE-0513
⑦	Horizontal Slip	SE-0474
⑧	CROSS, Alum	SE-4038
⑨	CENTER SUPPORT, 3-Way, Alum	SE-0310
⑩	CENTER SUPPORT, 4-Way, Alum	SE-0305
⑪	ELL, Iron	SE-4091
⑫	TEE, Iron	SE-4092
⑬	CROSS, Iron	SE-4093
⑭	CENTER SUPPORT, 2-Way, Iron	SE-0495
⑮	CENTER SUPPORT, 3-Way, Iron	SE-0482
⑯	CENTER SUPPORT, 4-Way, Iron	SE-0496
⑰	SIDE OUTLET TEE, Iron	SE-0437

Notes:

1. All assemblies are supplied standard with stainless steel fasteners.
2. Please specify options when ordering.

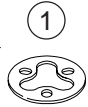

OPTIONS
ZINC 2
STAINLESS

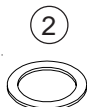

OPTIONS
ZINC 1
STAINLESS

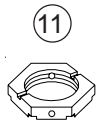
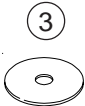

OPTIONS
W/O SETSCREWS
DOUBLE SETSCREWS



OPTIONS
W/O SETSCREWS
DOUBLE SETSCREWS
GALVANIZED

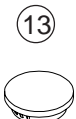

OPTIONS
COLOR: Yellow or Black

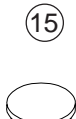

OPTIONS
COLOR: Yellow, Black, or Green

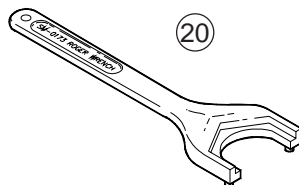

ITEM	DESCRIPTION	PART NO.
①	WASHER, Slotted	SE-0375
②	WASHER, .06" x 2.6" x 1.9"	SE-4061
③	WASHER, Single Stud, Stainless	SE-4113-SS
④	WASHER, Flat Nylon, 1-7/8" ID x 2-3/4" OD, Black	SE-0367
⑤	GASKET, Neoprene	SE-0354
⑥	GASKET, Slotted Tri-Bolt, Neoprene	AB-0278
⑦	SERRATED LOCKRING, Alum	SE-0360
⑧	SERRATED LOCKRING, Brass	SE-4029
⑨	DOUBLE SERRATED LOCKRING, Alum	SE-0451
⑩	CONDUIT LOCKNUT, Serrated, 1½"	SE-4125
⑪	CONDUIT LOCKNUT, 3/4"	SE-4048
⑫	HEX NUT, 1½", Iron	SE-4017
⑬	CHECK NUT, 1½", Alum	SE-0448
⑭	CHECK NUT, 1½", Iron	SE-0316
⑮	FITTING CAP, 1½"	SE-0304
⑯	FITTING CAP, 1¼"	SE-0419
⑰	CAP, 3/4" CGB Opening, Blue	AB-0271
⑱	TUBE CAP, Black	AB-0260
⑲	SIGNAL CLOSURE KIT	SE-3054
⑳	GROMMET, Neoprene w/ Diaphragm	SE-0449
⑲	ADAPTER RING, 3M, Alum	AB-0218
⑲	ICC PED HEAD SPACER, Alum	SE-0477
⑳	ROGER WRENCH w/ 10" Handle	SM-0173

Notes:

1. All assemblies are supplied standard with stainless steel fasteners.
2. Please specify options when ordering.

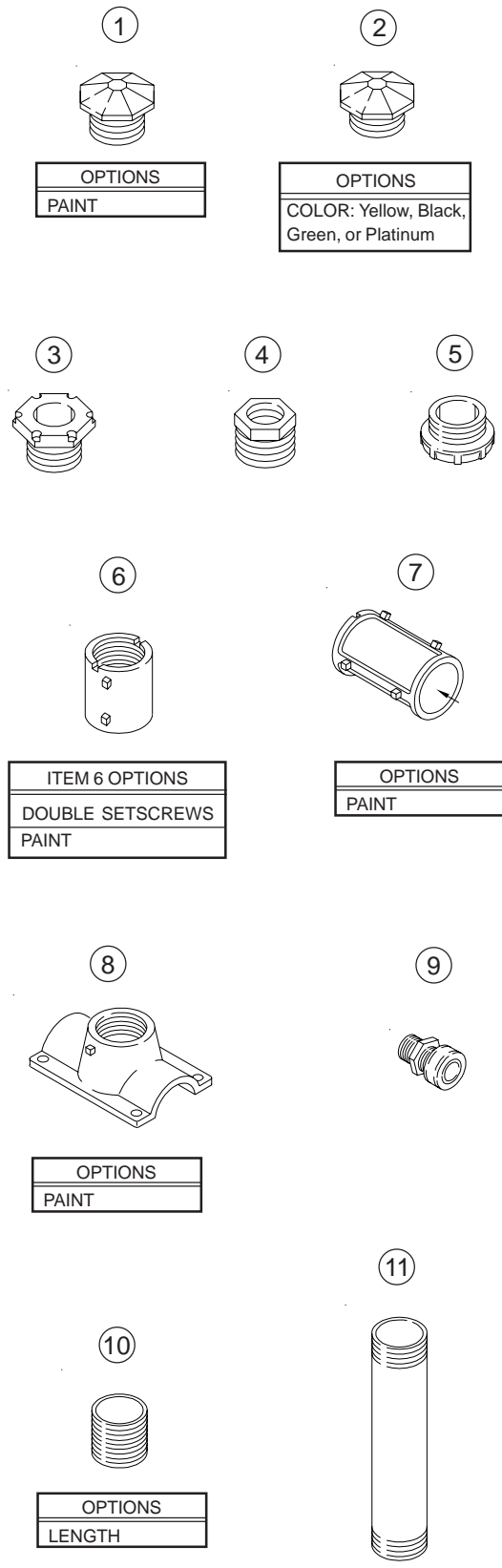

ITEM	DESCRIPTION	PART NO.
①	OCTAGONAL CLOSURE CAP, 1½" NPS x ½", Alum	SE-4088
	1½" NPS x 7/8", Alum	SE-0361
	1½" NPS x 1-3/8", Alum	SE-0483
	1½" NPS x 2", Alum	SE-0442
②	OCTAGONAL CLOSURE CAP, 7/8", Plastic	SE-0499
③	HEX NIPPLE, 1½" NPS, Alum	SE-0443
	CAST NIPPLE, 1½" NPS, Iron	SE-0435
④	REDUCER BUSHING, 1½" NPT x ¾" NPT, Iron	SE-0471
	½" NPT x 1" NPT, Iron	SE-0565
⑤	INSULATOR BUSHING, 1½" NPS	SE-4011
⑥	NOTCHED COUPLING, 1½" NPS x 2", Alum	SE-0346
	1½" NPS x 2", Steel	SE-4170
⑦	SLIP CONNECTOR, 1½" NPS, Alum	SE-0535
⑧	TUBE SADDLE, 1½", Alum	AB-0262
⑨	CGB, ¾", .55" to .65" Wire, Zinc 1	SE-4028
	¾", .625" to .75" Wire, Zinc 1	SE-0490
	1", .55" to .65" Wire, Zinc 1	SE-4216
⑩	ALL THREAD NIPPLE, 1½" NPS, Alum	SE-0309
	1½" NPS, Steel	SE-0492
	CLOSE NIPPLE, 1½" NPS x 1½" NPT, Steel	SE-4063
⑪	NIPPLE, 1½" NPS, Alum	SE-0436
	1½" NPS, Sch 80 Alum	SE-0475
	1½" NPS x 1½" NPT, Alum	SE-4214
	1½" NPS, Steel	SE-0469
	1½" NPT, Steel	SE-4200
⑫	SUPPORT TUBE, 1½" NPS, Alum	SE-0326
	2" NPS, Alum	SE-0494
	1½" NPS, Steel	SE-0491
⑬	TUBE, 1½" Alum	SE-0484

Notes:

1. All assemblies are supplied standard with stainless steel fasteners.
2. Please specify options when ordering.